

HOBBY

BRACELET & HEADBAND RIBBON ART FASHION ACCESSORIES

Instruction Booklet

6 YEARS & OLDER



WARNING:

CHOKING HAZARD - Small parts.
Not for children under 3 years.

BATTAT®

090908
BE1635A

©Battat

LIST OF MATERIALS



Ribbons x 28 pc



Headband
x 1 pc



Plastic Bangles
x 2 pc

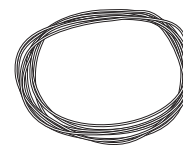

Colored Foil Wire
x 2 pc

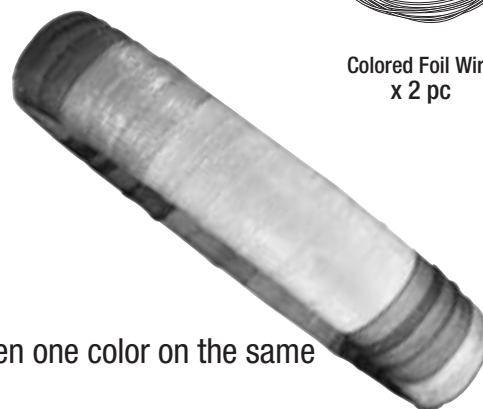

Simple ribbon design:

1. Choose a bangle or head band for your project
2. Choose the ribbons you want to use.
You can use more than one color on the same bangle or headband.
3. Place 1 glue square on the underside of one end of the ribbon. (You can cut the glue squares to better fit the ribbon.)
4. Press the glued end of the ribbon to the inside of the bangle or headband.
5. Tightly wrap the ribbon around the bangle or headband overlapping the ribbon on each turn.
6. If you want to add a different color ribbon:
 - position the end of the first ribbon so it is on the inside of the bangle or headband,
 - place a glue square on the underside of the ribbon and press firmly to the inside of the bangle or headband,
 - Cut off any extra ribbon.
 - Repeat steps 2 – 5
7. When you have finished wrapping the whole bangle or headband position the end of the ribbon so it is on the inside of the bangle or headband.
8. Place a glue square on the underside of the ribbon and press firmly to the inside of the bangle or headband.
9. Cut off any extra ribbon.

BANGLES

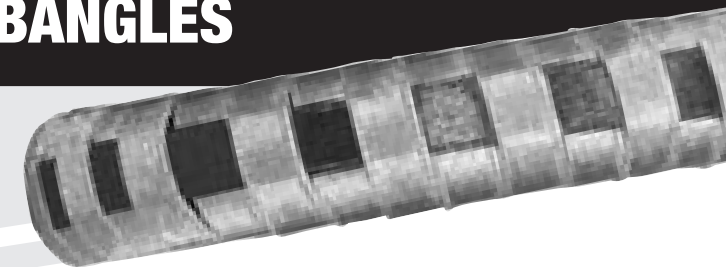

Checker bangle:

1. Choose a ribbon and wrap it less tightly around the bangle as described above, but do not make it too loose.
2. Choose another color ribbon.
3. Place a small piece of glue under the edge of the ribbon.
4. On the outside of the bangle, slide this end of the ribbon centered beneath the ribbon that was already wrapped around the bangle.
5. Now weave the new ribbon up and over the ribbon already wrapped around the bangle. Continue doing this until you have gone all the way around the bangle.
6. Place a small bit of glue on the underside of the ribbon and press firmly to the bangle.

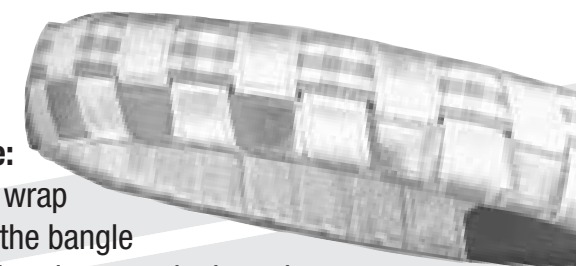

Double checker bangle:

1. Choose a ribbon and wrap it less tightly around the bangle as described above, but do not make it too loose.
2. Choose 2 more different colored ribbons.
3. Place a small piece of glue under the edge of each ribbon.
4. On the outside of the bangle, position the 2 ribbons next to each other with a small space between.
5. Weave one of the ribbons up and over the ribbon wrapped around the bangle. Continue doing this until you have gone all the way around the bangle. Repeat with the second ribbon.
6. Place a small bit of glue on the underside of each ribbon and press firmly to the bangle.

© Battat

CORSET

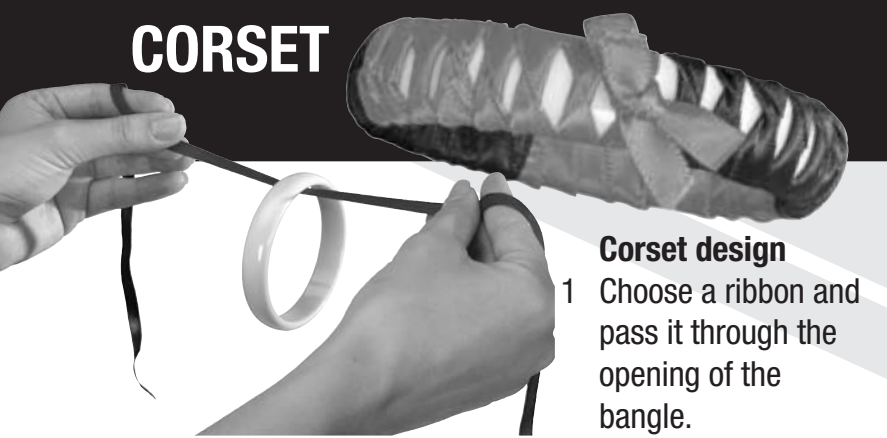

Corset design

- 1 Choose a ribbon and pass it through the opening of the bangle.

Adjust the ribbon ends so the lengths are even.

- The shiny side of the ribbon should face down.
- Tie a knot around the bangle, just like when you tie your shoes (without the buckle). Pull on both ribbon ends to tighten.
- Keep the knot at the center of the bangle.

- 2 Take the right ribbon and flip it at the top of the bangle, so both ends of the ribbon are up.

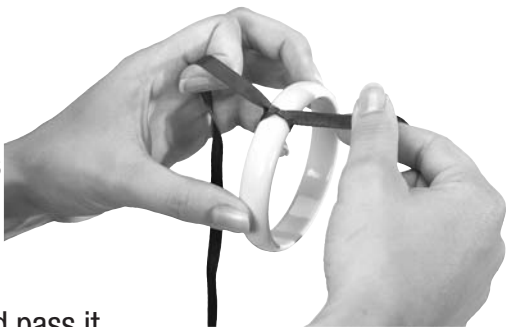

- 3 Take the right ribbon and pass it through the bangle to the left side.

Take the left ribbon and pass through to the right side.

- Tie another knot. Try to keep the knots all in line.
- Repeat these steps until you only have 3" (8cm) of ribbon left on each end, or if you want to change for another ribbon.
- Tie a nice bow to finish.

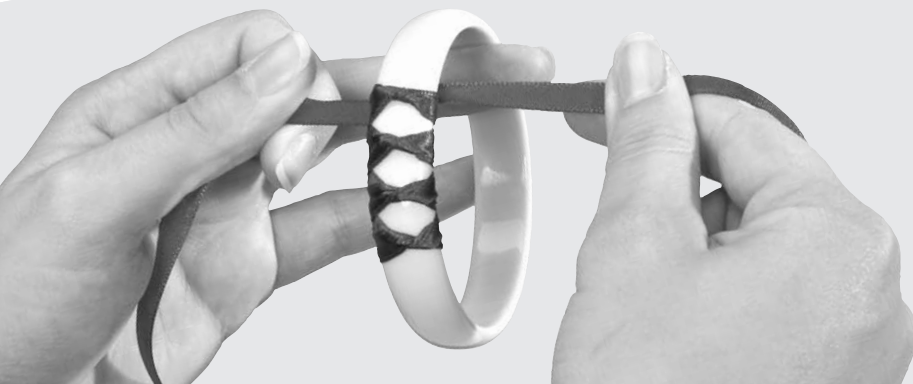

ROMANTIC

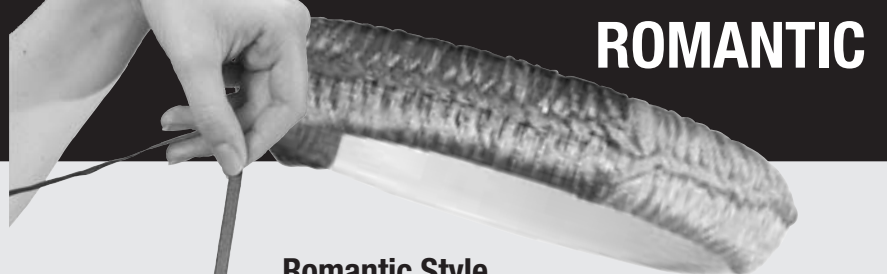

Romantic Style

- 1 Choose your ribbon and glue one end to the outside of the bangle.



- 2 Hold the ribbon straight up with your left index finger.

- Use your right hand to put the end of the ribbon through the bangle.
- Thread the free end of the ribbon behind the strip of ribbon you are holding up with your left index finger.

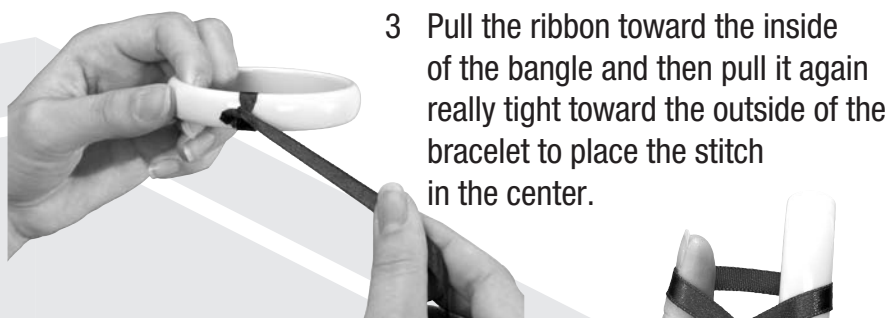

- 3 Pull the ribbon toward the inside of the bangle and then pull it again really tight toward the outside of the bracelet to place the stitch in the center.

- 4 Repeat these steps and bring the stitches together each time you have 3 in order to tighten them, for a nicer look.

- Stop when you only have 1" (3cm) of ribbon left. Glue the ribbon end to the inside of the bangle.
- Cut off any extra ribbon.



STRIPED & BEADED



Striped design

- 1 Choose 2 ribbons.
- 2 Place 1 glue square on the inside of the bangle.
- 3 Press the 2 ribbons on to the glue inside of the bangle overlapping them by 2 mm.
- 4 Wrap the ribbons together around the bangle, keeping them evenly overlapped.
- 5 When you have finished wrapping the whole bangle, position the ends of the ribbon so they are inside of the bangle.
- 6 Place a glue square on the underside of the ribbons and press firmly to the inside of the bangle.
- 7 Cut off any extra ribbon.

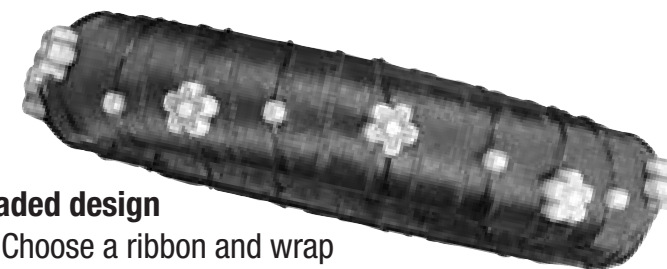

Beaded design

- 1 Choose a ribbon and wrap it around the bangle as described above.
- 2 Choose a wire and the beads you would like to use.
- 3 Make one loop around the bangle with the wire.
- 4 Twist the wire ends to make a knot. Make sure the knot is on the inside of the bangle so it does not show.
- 5 Wrap the wire around the bangle leaving about 1/4" (1cm) between each loop. Thread the beads on to the wire before you make each new loop. Make sure the beads are on the outside of the bangle.
- 6 Repeat these steps until you are back to the first loop.
- 7 Tie off the wire by threading the free end through the last loop and twist.
- 8 Cut off any extra wire.